



Room Dimensions & Seating Capacity

Room Name	Square Feet	Dimensions	Height	Theater	Classroom	Banquet	Reception	HSquare	Exhibit 8x10	Exhibit 10x10
Conference Center Second Floor										
Lone Star Ballroom	40,800	240' x 170'	24' - 30'	4,500	3,000	3,200	5,000	—	238	205
A 1, 2, 3, 4 & C 1, 2, 3, 4	3,360	80' x 42'	24' - 30'	380	225	250	360	60	20	17
B	13,680	171' x 80'	24' - 30'	1,500	850	1,000	1,500	—	75	55
Preconvene	27,148	—	14' - 16'	2,700	1,800	2,250	3,000	—	146	105
Conference Center Third Floor										
Preconvene	8,770	—	—	—	—	—	—	—	—	—
Houston Ballroom	7,560	126' x 60'	13' - 15'	850	450	600	900	—	40	32
A, B, C each	2,520	60' x 42'	13' - 15'	250	180	200	300	60	13	10
San Antonio Ballroom	4,590	102' x 45'	12' - 14'	530	300	350	510	—	26	20
A, B each	2,295	51' x 45'	12' - 14'	260	100	150	270	56	15	12
State Room 1	1,066	41' x 26'	9'8"	100	70	80	120	30	—	—
State Room 2	1,066	41' x 26'	9'8"	100	70	80	120	30	—	—
State Room 3	1,122	33' x 34'	9'8"	100	60	80	130	30	—	—
State Room 4	1,122	33' x 34'	9'8"	100	60	80	130	30	—	—

Sheraton Dallas Hotel

400 North Olive Street, Dallas, Texas 75201
T 214 922 8000 sheraton.com/dallas

Room Dimensions & Seating Capacity

Room Name	Square Feet	Dimensions	Height	Theater	Classroom	Banquet	Reception	HSquare	Exhibit 8x10	Exhibit 10x10
Conference Center First Floor										
Grand Hall/Preconvene	40,000	—	17' - 18'	2,744	1,568	3,000	4,500	—	240	196
Dallas Ballroom	24,624	228' x 108'	17' - 18'	2,800	1,620	2,000	2,800	—	132	112
A or D 1, 2, 3 each	2,240	64' x 35'	17' - 18'	230	120	160	270	52	14	10
B or C	5,400	108' x 50'	17' - 18'	650	300	460	800	—	28	24

Conference Center Second Floor

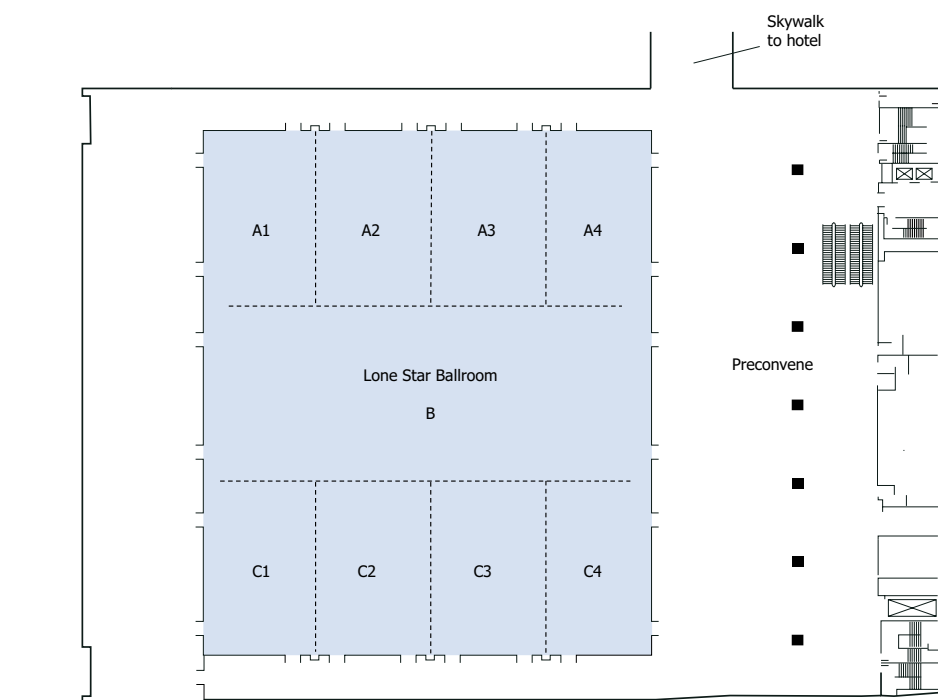

Conference Center Third Floor

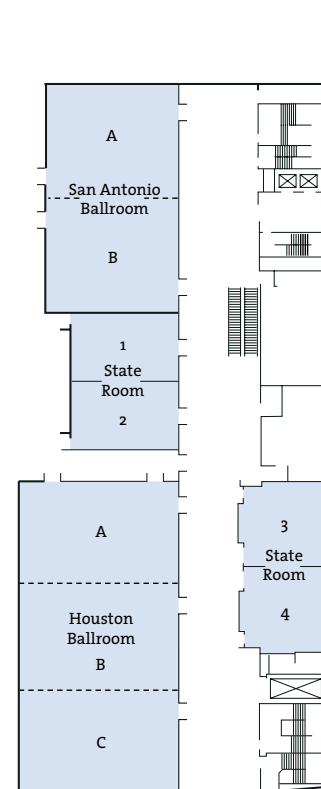

Conference Center First Floor

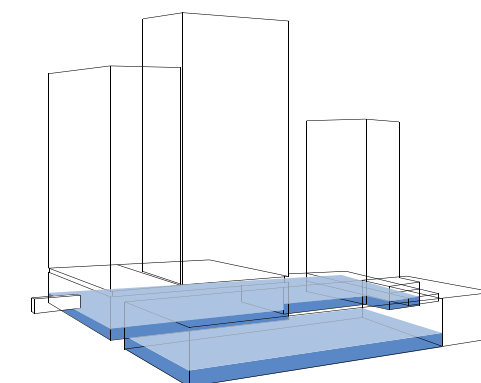
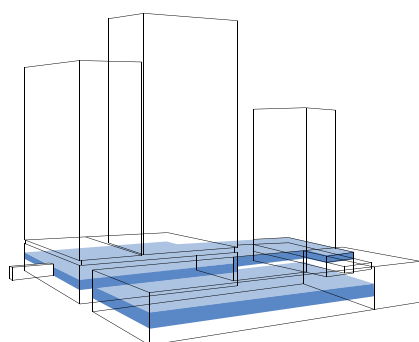
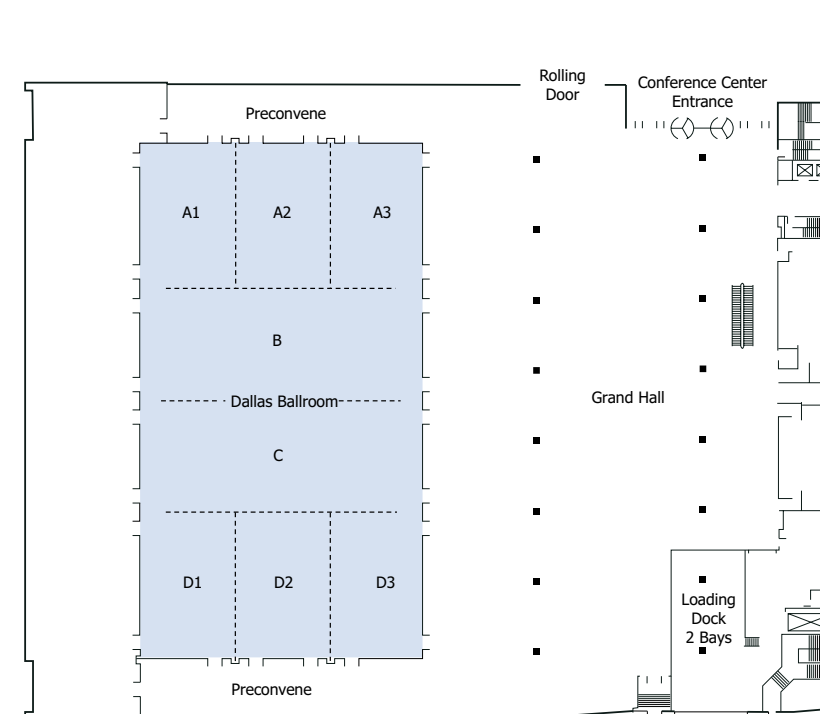

Room Dimensions & Seating Capacity

Room Name	Square Feet	Dimensions	Height	Theater	Classroom	Banquet	Reception	HSquare	Exhibit 8x10	Exhibit 10x10
Hotel Second Floor										
Preconvene	2,822	—	11'	—	—	—	300	—	—	—
Austin Ballroom	7,667	135' x 58'	16' x 18'	900	450	600	870	—	50	40
1 & 3 each	2,378	58' x 40'	16' x 18'	170	120	200	240	60	16	13
2	3,132	58' x 55'	16' x 18'	280	160	230	340	80	20	16
Pearl 1	425	25' x 17'	9'8"	30	20	30	45	12	—	—
Pearl 2	425	25' x 17'	9'8"	30	20	30	45	12	—	—
Pearl 3	340	20' x 17'	9'8"	20	20	20	35	10	—	—
Pearl 4	650	26' x 25'	9'8"	70	48	50	80	18	—	—
Pearl 5	546	26' x 21'	9'8"	50	30	40	60	16	—	—
Press Club	2,809	53' x 153'	10'	150	75	110	225	50	17	14
Live Oak	650	26' x 25'	10'	70	48	50	80	18	—	—
Seminar	2,067	—	10' tiered	—	80	—	—	—	—	—
Executive Boardroom	756	28' x 27'	10'	—	—	—	—	14	—	—
Hotel Third Floor										
Trinity 1	836	44' x 19'	9'	85	45	60	70	34	—	—
Trinity 2	741	39' x 19'	9'	60	30	40	60	16	—	—
Trinity 3	570	30' x 19'	9'	50	30	40	50	16	—	—
Trinity 4	648	24' x 27'	9'	50	30	40	75	18	—	—
Trinity 5	675	25' x 27'	9'	50	30	40	60	15	—	—

Hotel Second Floor

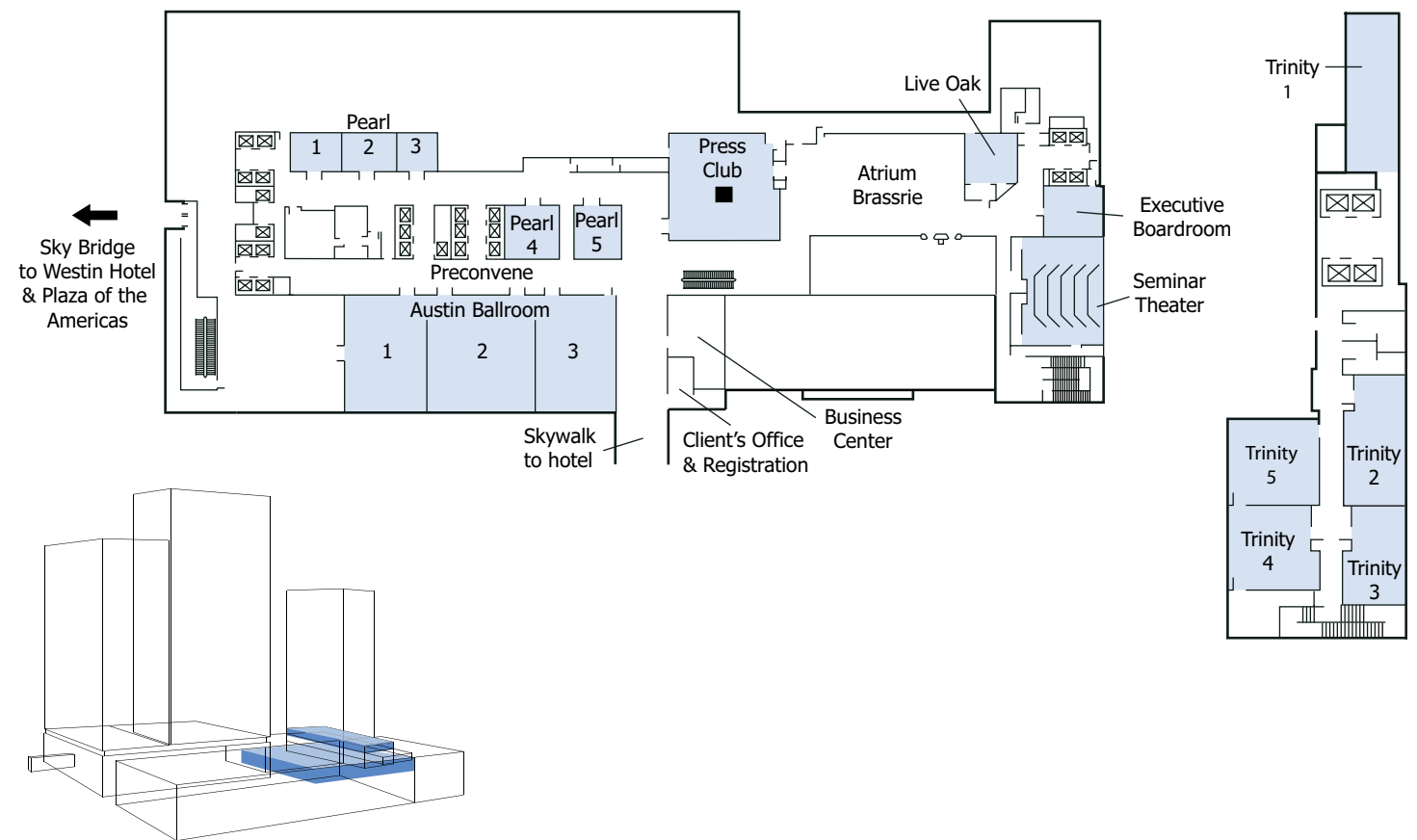

Hotel Third Floor

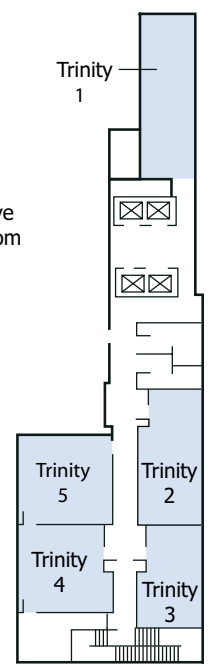

Room Dimensions & Seating Capacity

Room Name	Square Feet	Dimensions	Height	Theater	Classroom	Banquet	Reception	HSquare	Boardroom
Hotel Fourth Floor									
City View Rooms									
1 - 3 each	729	27' x 27'	8'10"	70	35	50	70	18	16
4	486	27' x 18'	8'10"	35	25	40	50	14	12
5	3,567	27' x 21'	8'10"	30	20	40	55	14	12
6 & 8 each	1,242	46' x 27'	8'10"	110	70	80	140	32	20
7	1,050	42' x 25'	8'10"	100	70	80	125	26	20
Remington	3,716	92' x 55'	8'10"	250	160	250	430	50	75
Hotel 37th Floor									
Majestic Rooms									
1	1,890	54' x 35'	8'10"	165	80	100	200	50	—
2	945	35' x 27'	8'10"	—	—	22	—	—	22
3, 4, 7, 8 each	945	35' x 27'	8'10"	90	54	60	100	25	—
5, 6 each	1,200	48' x 25'	8'10"	137	60	80	125	32	—
4 & 5 or 6 & 7 each	2,640	55' x 48'	8'10"	200	120	350	280	42	—
9, 11 each	459	27' x 17'	8'10"	40	20	20	50	12	—
10	459	27' x 17'	8'10"	—	—	12	—	—	12

Hotel Fourth Floor

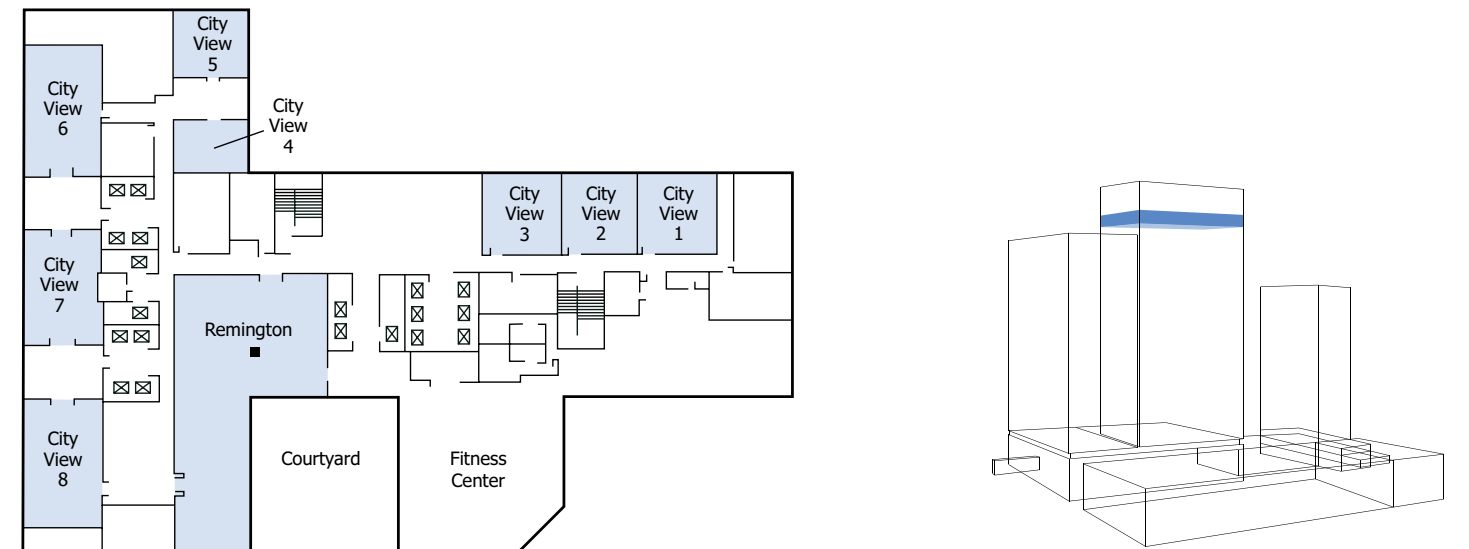

Hotel 37th Floor

