

HYATT LODGE

AT McDONALD'S CAMPUS

2815 JORIE BOULEVARD
OAK BROOK, IL 60523

T + (630) 568 1234

F + (630) 581 6619

thelodge.hyatt.com



you're more than welcome

2018.13

Accommodations

- 218 guestrooms consisting of: Suites, Parlors, Kings and Double Queen Rooms
- Seven ADA Accessible Rooms
- Hyatt Grand Bed™
- Turndown service available upon request
- High Definition LCD flat-screen television
- Video messages, video account review, video checkout
- Voice mail and telephone with message light
- iHome® alarm clock radio
- Full bath amenities and hair dryer
- Iron / ironing board, and individual climate control
- In-Room Safe
- Coffeemaker and mini refrigerator
- Hardwood Entry Floor

Conferences & Banquets

- A total of 47,000 square feet of function space
- 5,100 sq. feet ballroom and 3,800 sq. feet Grand Oaks Pavilion
- Connected to McDonald's Conference Center, Hamburger University, featuring 33,210 sq. feet of meeting space including a 299-seat auditorium, and two tiered classrooms that accommodate 110 people each
- All 44 meeting rooms feature individual or master controls for heat / AC and sound; telephones; multiple electrical / microphone outlets
- Dirk Lohan designed Prairie-style architecture in a retreat-like setting

Location

Discover a private retreat in the heart of Oak Brook, IL. The Hyatt Lodge at McDonald's Campus offers exceptional amenities in an unparalleled natural setting.

Directions

From O'Hare Int'l Airport (15 miles): Take I-294 South to I-88 West. Exit I-88 at 83 North (Cermak Rd)-1st exit after toll booth. At stoplight (22nd St / Cermak Rd), turn right and go two stoplights to Jorie Blvd. Turn right on Jorie Blvd to the third stoplight (Kroc Dr). Turn left. At stop sign turn left on Ronald Lane. Hotel is on left.

Points of Interest

- Oak Brook Shopping Center
- Brookfield Zoo
- Morton Arboretum
- Riverboat Casinos
- Drury Lane Theatre
- Frank Lloyd Wright Home & Studio
- Graue Mill and Museum
- Yorktown Center
- Pinstripes Bowling and Bocce Ball Facility

Services & Facilities

- Hyatt Fast Board™
- Self-serve Business center
- Assistive devices for persons with disabilities
- Valet services and parking
- Multilingual staff, currency exchange, ATM
- Safe-Deposit Boxes
- Vending area with microwaves

Restaurants, Bar & Lounge

- **WATER'S EDGE** — Contemporary take on American Classics open for Breakfast, Lunch and Dinner
- **HEARTH LOUNGE** — Serving Cocktail and Appetizers
- **WATER'S EDGE EXPRESS** — Quality Experience with Quick Take-out Style - Delivery or Pick-up

Recreational Facilities

- **MIDTOWN FITNESS CENTER** — includes state-of-the-art cardiovascular equipment, weight training, aerobics, and personal trainers
- **MIDTOWN SPA** — specializes in spa manicures, pedicures and extensive massage therapy services
- **INDOOR POOL** — 70-foot lap pool designed for water sports; three whirlpools; sauna and steam-room
- Team Challenge Adventure Course
- Complimentary Bicycles (Seasonally Available)
- Four miles of jogging trails and five hiking / biking paths

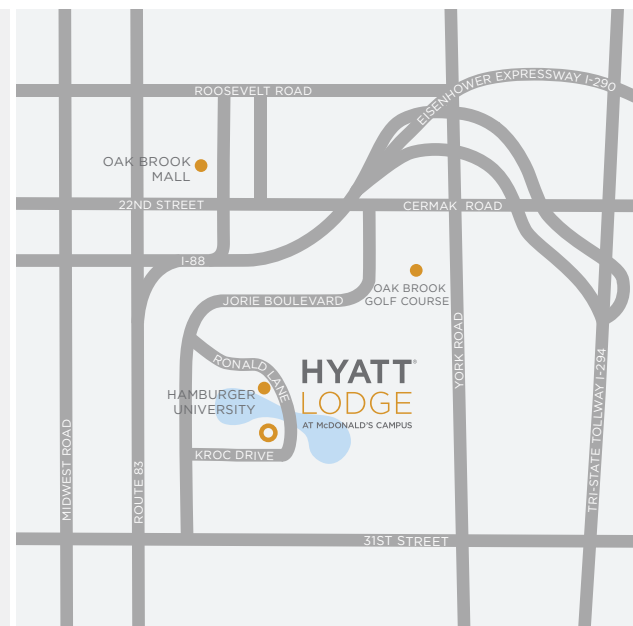

HYATT LODGE

AT McDONALD'S CAMPUS

2815 JORIE BOULEVARD

OAK BROOK, IL 60523

T + (630) 568 1234

F + (630) 581 6619

thelodge.hyatt.com



you're more than welcome

2018.13

Hyatt Lodge Floorplan

BALLROOM LEVEL

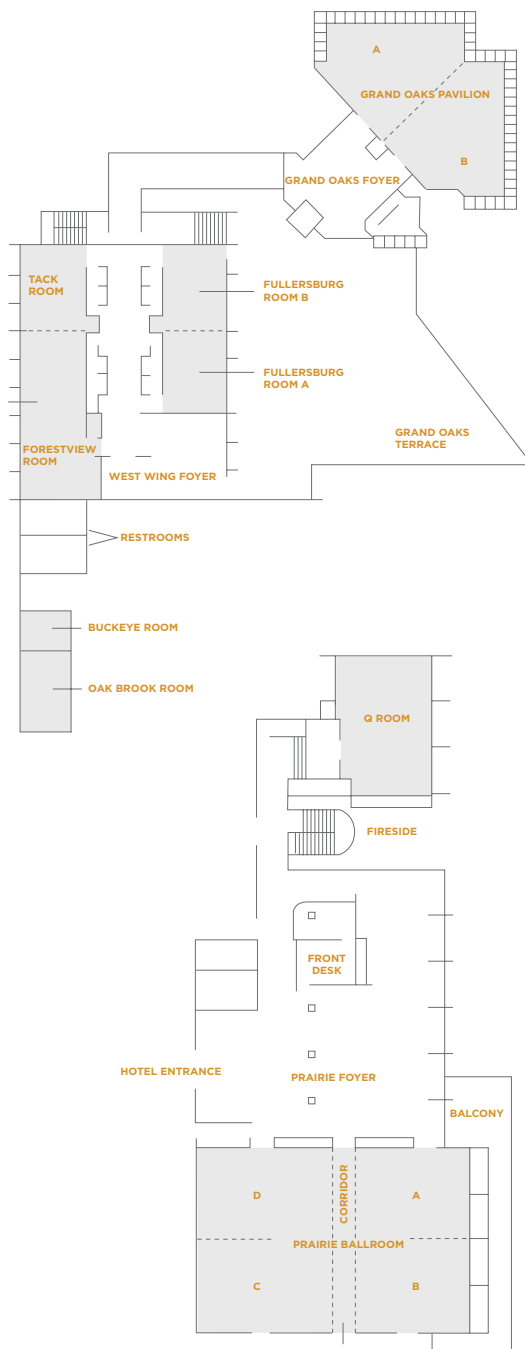

HYATT LODGE

AT McDONALD'S CAMPUS

2815 JORIE BOULEVARD
OAK BROOK, IL 60523

T + (630) 568 1234
F + (630) 581 6619

thelodge.hyatt.com



you're more than welcome

2018.13

Hyatt Lodge Room Capacities & Dimensions



Room Name	Room Dimensions L x W x H	Room Size Sq. Ft.	Banquet	Reception	Theater	Classroom	Boardroom	U-Shape	Hollow Square	Table Top Exhibits
BALLROOM LEVEL										
Praire Ballroom	58' x 88' x 14'6"	5,104	350	450	500	300	—	—	—	50
Prairie A + B + Corridor	58' x 47' x 14'6"	2,726	150	250	250	144	—	—	—	40
Prairie C + D + Corridor	58' x 47' x 14'6"	2,726	150	250	250	144	—	—	—	40
Prairie A + B or C + D	40' x 58' x 14'6"	2,320	150	225	200	115	—	56	68	20
Prairie A, B, C or D	40' x 29' x 14'6"	1,160	60	100	100	40	30	30	38	10
Prairie Foyer	64' x 30' x 12'	1,920	100	—	—	—	—	—	—	15
Q Room	38' x 28' x 12'	1,064	70	100	70	40	20	20	24	8
Forestview Room	51' x 24' x 8'	1,224	70	125	115	55	55	50	55	10
Fullersburg Room A+B	51' x 21' x 8'	1,113	70	125	115	55	55	50	55	10
Fullersburg Room A or B	51' x 21' x 8'	546	30	30	30	18	20	15	20	4
Tack Room	51' x 24' x 8'	504	30	30	30	18	20	15	20	4
Buckeye Room	51' x 24' x 8'	312	—	—	—	—	8	—	—	—
Oak Brook Room	51' x 24' x 8'	416	—	—	—	—	16	—	—	—
Grand Oaks Pavilion	96' x 108' x 12'	3,800	200	250	200	125	—	—	—	20
Grand Oaks Pavilion A	55' x 53' x 12'	1,900	100	125	75	—	—	—	—	10
Grand Oaks Pavilion B	41' x 55' x 12'	1,900	100	125	75	—	—	—	—	10
Grand Oaks Foyer	34' x 34' x 12'	1,156	40	—	—	—	—	—	—	5
West Wing Foyer	21' x 24' x 8'	504	30	—	—	—	—	—	—	3
Fireside	26' x 24' x 20'	—	30	30	—	—	—	—	—	—

HYATT LODGE

AT McDONALD'S CAMPUS

2815 JORIE BOULEVARD

OAK BROOK, IL 60523

T + (630) 568 1234

F + (630) 581 6619

thelodge.hyatt.com



you're more than welcome

2018.13

Hamburger University Floorplans

FIRST LEVEL

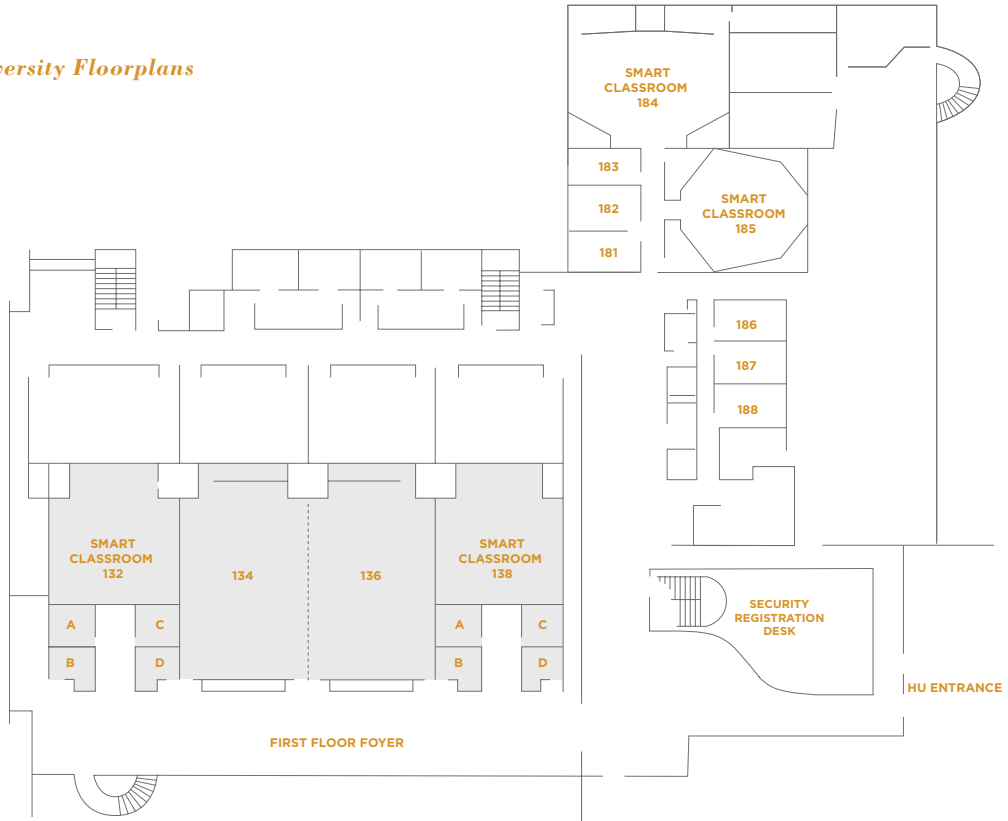

Hamburger University Floorplans

SECOND LEVEL

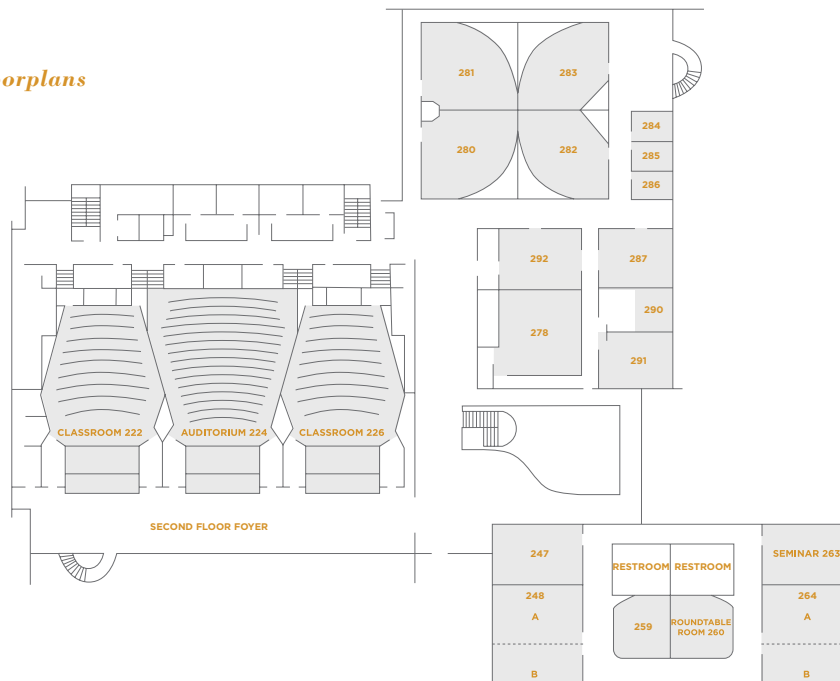

HYATT LODGE

AT McDONALD'S CAMPUS

2815 JORIE BOULEVARD
OAK BROOK, IL 60523

T + (630) 568 1234

F + (630) 581 6619

thelodge.hyatt.com



you're more than welcome

2018.13

Hamburger University Room Capacities & Dimensions



Room Name	Room Dimensions L x W x H	Room Size Sq. Ft.	Banquet	Reception	Theater	Classroom	Boardroom	U-Shape	Hollow Square	Table Top Exhibit
HAMBURGER UNIVERSITY (FIRST LEVEL)										
SMART Classrooms* 132 / 138 / 184 / 185	36' x 42' x 9'	1,512	—	—	—	—	—	—	—	—
Rooms 132, A, B, C or D	14' x 11' x 9'	154	—	—	—	—	6	—	—	—
Rooms 138, A, B, C or D	14' x 11' x 9'	154	—	—	—	—	6	—	—	—
Rooms 134 / 136	36' x 56' x 9'	2,016	100	125	150	90	—	45	50	11
Rooms 134 + 136	72' x 56' x 9'	4,032	220	250	250	160	40	45	60	22
Rooms 181 / 182 / 183	19' x 12' x 9'	228	—	—	—	—	6	—	—	—
Rooms 186 / 187 / 188	18' x 12' x 9'	216	—	—	—	—	6	—	—	—
First Floor Foyer	—	—	100	—	—	—	—	—	—	12

HAMBURGER UNIVERSITY (SECOND LEVEL)

Tiered Classroom 222 or 226	48' x 56' x 15'10"	2,260	—	—	—	120	—	—	—	—
Tiered Auditorium 224	59' x 62' x 15'10"	2,880	—	—	299	—	—	—	—	—
Rooms 247/248 A or B	24' x 32' x 9'	768	40	—	—	25	20	20	25	—
Rooms 248/264 A + B	32' x 32' x 9'	1,536	100	80	100	55	30	36	40	10
Room 259	22' x 26' x 9'	572	—	—	25	15	10	15	—	—
Roundtable Room 260	22' x 32' x 9'	572	—	—	—	—	17	—	—	—
Rooms 263/264 A or B	24' x 32' x 9'	768	40	—	—	25	20	20	25	—
Room 278	32' x 34' x 15'	1,088	60	—	75	50	—	32	36	10
Rooms 280 / 281 282 / 283	36' x 36' x 9'	1,296	60	80	75	40	20	20	25	10
Rooms 284/285/286	14.5' x 14.5' x 9'	166.75	—	—	—	—	6	—	—	—
Room 287	23' x 28' x 9'	644	30	—	25	15	10	15	—	—
Room 290	12' x 17' x 9'	204	—	—	—	—	12	—	—	—
Room 291	22' x 28' x 9'	616	30	—	25	15	10	15	—	—
Room 292	23' x 32' x 9'	736	30	—	25	15	10	15	—	—
Second Floor Foyer	—	—	120	—	—	—	—	—	—	14